

evoke®

flooring that can take it

LAMINATE

INSTALLATION INSTRUCTIONS
With 1 CLIC 2GO PURE DROP LOCK



Part 1

Installation Method: 1 Clic 2go Pure Drop Lock Joint System

PLEASE READ THESE INSTRUCTIONS COMPLETELY BEFORE BEGINNING THE INSTALLATION:

Evoke flooring is designed for easy, snap-together installation. Evoke flooring can be installed:

- In rooms on, above or below ground level.
- Over plywood, OSB or concrete subfloors.
- Directly over most existing hard surface flooring.
- Over radiant heating systems.

In commercial applications, Evoke laminate may be used in locations where moderate to heavy customer traffic is expected, including but not limited to offices, retail stores and restaurants, medical/dental clinics, salons, etc. Evoke Laminate should not be installed in locations where there is frequent exposure to spilled liquids (bars, public washrooms, etc.) or heavy rolling loads (warehouses, hospitals, big box stores, etc.)

Installer's / Owner's Responsibility

Evoke flooring is manufactured to highest standards of product quality, but occasional manufacturing defects may occur in the product. It is the sole and joint responsibility of the installer and owner to conduct a quality inspection of all pieces Evoke flooring before installation. Any pieces of flooring that appear to contain a manufacturing defect should not be installed. Flooring that has been installed will be deemed to have been inspected and accepted by the installer and owner, even if the owner is not present at the time of installation. If defects are found, please contact your dealer. It is the sole responsibility of the flooring installer to ensure that the job site, subfloor, and installation, and materials meet or exceed all applicable industry standards. Evoke accepts no responsibility for problems arising from incorrect or improper site preparation or installation procedures.

Very important: Evoke laminate is made from wood and wood-based products, and like any wood product it will react to changes in the environment. Please pay special attention to instructions regarding on site acclimatization, required expansion space, and temperature and humidity levels.

SITE PREPARATION

INSTALLATION IN NEWLY-CONSTRUCTED HOME

Installation of laminate flooring is one of the last jobs of a new home construction. Prior to installing a laminate floor, ensure that:

- The building is completely enclosed with all outside doors and windows in place and securable, including a door from an attached garage to house interior
- All concrete, masonry, plastering, drywall, texturing, painting and other wet work is complete and thoroughly cured and dry
- Evoke laminate is floating floor system, so all floor mounted cabinetry (including kitchen islands, bathroom vanities, etc.) should be installed and secured prior to installing the laminate floor. Mounting cabinetry on top of the laminate floor has a pinning effect that impedes the natural seasonal expansion and/or contraction of the laminate that may result in edge and/or end-gapping.
- Basements and crawlspaces are dry. Crawlspaces must have no standing water; crawlspaces must also have a vapour barrier and adequate ventilation in accordance with local building codes.
- Gutters and downspouts are in place, directing water away from the building
- HVAC systems are fully operational, enabling heat and humidity levels to be controlled and maintained throughout the home
- Subfloor is properly prepared for installation
- If installing over radiant heat, ensure that the system is in full working order and has been fully tested and running for a minimum of two weeks prior to install

INSTALLATION IN EXISTING HOME (RENOVATION)

Installation in an existing home must meet the same conditions as a new home. If part of a larger remodeling project, ensure that all wet work (painting, wallpapering, texturing, etc.) is completed and thoroughly dry before commencing flooring installation. In addition:

- Remove all furniture, artwork and other valuables from installation area
- Remove baseboards and moldings
- Undercut door casings (use a piece of the flooring as a depth gauge)
- Remove existing flooring, if necessary
- Evoke laminate is floating floor system, so any renovations that include floor mounted cabinetry (including kitchen islands, bathroom vanities, etc.) should be installed and secured prior to installing the laminate floor. Mounting cabinetry on top of the laminate floor has a pinning effect that impedes the natural seasonal expansion and/or contraction of the laminate that may result in edge and/or end-gapping.

RADIANT HEAT SYSTEMS

Evoke laminate floors are suitable for installation over compatible in-floor radiant heat systems. It is the homeowner's responsibility to determine if the radiant heat system being considered is compatible for use under the floor being installed. We recommend that the homeowner contact the system manufacturer and get written confirmation that the system is approved for use with laminate flooring and under what operating conditions. Please contact the Evoke Technical Services Team at techserv@metrofloors.com for more information.

Prior to installation, ensure that the radiant heat system is in full working order and has been fully tested and running for a minimum of two weeks. The system should be turned off for 24 hours prior to installation in the install zone.

After installation, Evoke recommends that the surface temperature of the floor never be allowed to exceed 82°F (28°C) and that changes in temperature be moderated in increments of 5°F (2°C) to avoid 'shocking' the floor.

Where possible, we recommend the use of a data logger to monitor and record temperature and humidity conditions; this provides a record of the environmental conditions and may also help take preventive measures where conditions are outside of recommended levels.

CLIMATE CONTROL

Conditions at the job site must be maintained with the temperature between and 60-80°F (15-26°C) humidity at 30-50% RH before, during and after the installation.

Flooring material should not be delivered to job site until these conditions have been met and maintained for one week prior to installation if installing over plywood, and for two weeks if installing over concrete.

When temperature and humidity have met the conditions detailed above, material may be delivered to the job site. Do not deliver flooring to job site if climate conditions have not been met and maintained as described above otherwise damage to product may result.

Following installation, these conditions should be maintained at all times to ensure proper performance of the floor. See Warranty for details.

ACCLIMATION

Once the site is under control as previously outlined, material brought to the site should have a minimum of 24-48 hours for the flooring to become balanced to the install sites interior temperature and humidity. If stacking the boxes, cross-stack to ensure good air flow between layers.

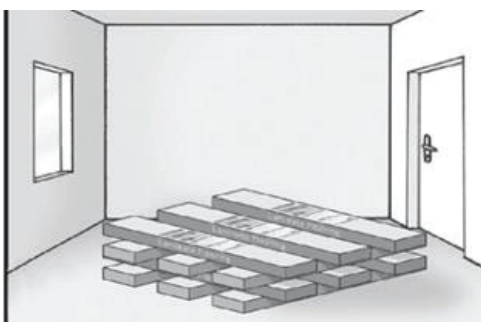

Do not open the boxes; leave closed until ready to commence the installation, and then open only as needed.

SUBFLOOR PREPARATION

The installer and customer are jointly and solely responsible for ensuring that the subfloor is suitable for the flooring application and properly prepared for installation.

All subfloors must be clean, dry, structurally sound and flat to within 3/16" in 10'. When floating over pre-existing floors such as ceramic tile, all grout-lines must be leveled with a suitable bonding-filler and inspected for proper adhesion.

Wood/Plywood Subfloors must be tested for moisture content and the subfloor moisture content should not exceed 12%. Subfloors must meet local building code requirements.

Truss/joist spacing (Measured on center)	Minimum acceptable thickness 4 x 8 sheets
16" (406mm) or less	5/8" (19/32", 15.1mm) CD Exposure 1 Plywood -or- 3/4" (23/32") Exposure 1 OSB
More than 16" (406mm) up to 19.2" (488mm)	3/4" (23/32", 18.3mm) T&G CD Exposure 1 Plywood, glued and mechanically fastened -or- 3/4" (23/32", 18.3mm) Exposure 1 OSB, glued and mechanically fastened
More than 19.2" (488mm) to a max. of 24" (610mm)	7/8" T&G CD Exposure 1 Plywood, glued and mechanically fastened -or- 7/8" Exposure 1 OSB, glued and mechanically fastened -or- two layers of subflooring

While every effort has been made to produce accurate and generally accepted guidelines, the principles and practices described in this publication are not universal requirements. The recommendations in this publication are directed to the North American market in general, and therefore may not reflect the most accepted industry practices in your geographical area. All flooring installations must conform to the local building codes, ordinances, trade practices and climate conditions.

Concrete subfloors must be visibly dry and clean. They should be fully cured (minimum 30 days) and have been tested for moisture content using the ASTM F2170 – RH Probe Test standard; the maximum allowable limit of relative humidity within the slab is 75%.

Or if using the test method:

ASTM F1869 – Calcium Chloride Test: the moisture vapor emissions rate (MVER) should not exceed 3lbs / 1000 Sq. Ft. per 24 hours.

If these conditions cannot be met, further curing will may be required, or a moisture barrier should be used to mitigate any moisture coming from below. This will help prevent the flooring material from being damaged by moisture [vapor]. Either a roll on type sealer, or 6-mil polyfilm sheeting, or an underlayment that achieves a perm rating of .1 can be used on top of the concrete for this additional layer of protection.

Gypsum-based concrete (i.e. Gypcrete) subfloors must meet concrete manufacturer's recommendations for dry, cured conditions.

VAPOR BARRIER & UNDERLAY

When installing laminate over a concrete subfloor that is either on, above, or below-grade, a Class I perm rated vapor barrier **must be** placed between the laminate and the concrete subfloor.

As listed by the North American Laminate Flooring Association (NALFA), some acceptable vapor barriers/retarders over concrete include:

1. A minimum 6 mil construction grade polyethylene film or other impermeablesimilar material. The above listed vapor barrier/retarders should be installed in the following manner:

- Lay a single layer of poly over the entire subfloor.
- Allow a 12 inch overlap between seams, and seal the seams with ducttape along their entire length.
- Leave an excess of 4 inches of material extending up the wall at all outeredges and hold in place with blue or painter's masking tape. (This excesswill be trimmed away later.)
- Next install an appropriate underlay over the entire subfloor surface. Theseams should butt, not overlap.

2. An underlayment providing a class I perm rated moisture protection and having a vapor transmission factor of less than 3 lbs/1000 sq. ft. /24 hours.

Evoke recommends PRO SERIES KOMFORT+ series 30 and 50 type underlaysfor this purpose.

A Class I perm rated vapor barrier **must also be installed** over below-grade concrete subfloors, prior to floating any additional wood or composite subfloor layers on which you are planning to install laminate flooring.

When installing laminate flooring on plywood or OSB subfloors that are on or above-grade, we recommend the use of our PRO SERIES KOMFORT+ underlays, or a comparable 3-in-1 underlayment.

Note: As per NALFA guidelines, when installing laminate flooring over wood or OSB subfloors, do not use a Class I perm rated vapor barrier, such as 6-mil polyethylene film or other polymer materials, as it may trap moisture on or in the wood subfloor. This also applies when installing pad-attached laminates.

CRAWL SPACES

Our PRO SERIES KOMFORT+ underlays or a comparable 3-in-1 underlayment may be used when installing laminate flooring over a plywood or OSB subfloor which is above a crawlspace, provided the crawlspace meets the following NALFA criteria:

- Crawl space should be a minimum of 18" (457mm) from ground to underside of joists.
- Crawl space earth (or thin concrete slab) should be covered 100 percent by a vapor retarder of black polyethylene (minimum 6 mil) or any recommended puncture-resistant membrane, such as Class C, meeting ASTM D1745.
- Where a proper ground covering is in place and when venting is required by local building codes, the crawl space should have perimeter venting equal to a minimum of 1.5 square feet per 100 square feet of crawl space square footage.
- For crawl spaces without ventilation openings, vapor retarder joints must overlap a minimum of 6 inches and be sealed or taped. The vapor retarder should also extend at least 6 inches up the stem wall and be attached and sealed to the stem wall. Continuously operated mechanical exhaust and perimeter wall insulation or conditioned air supply and insulation **must be provided**.

INSTALLATION

STARTING WALL

When possible orient the installation so the boards are parallel to incoming sunlight and select your starting wall. Check it for straightness. If it is not straight, you may need to trim the edge of the first row of floorboards to match the shape of the wall. Calculate how many rows of flooring will be required for the job. You will probably have to rip down (cut lengthwise) the final row of boards to fit. The final row must be at least half a board width wide to ensure the integrity of the joint. If it will not be half a board width, then rip down your starting row enough to make up the difference. Please note that whenever the widths of the boards are modified, the locking mechanism of the end-joint may become compromised. It is recommended that the end-joints of these rows be glued together using a non-crystallizing wood flooring glue (e.g. Deccobond). Do not glue boards directly to the subfloor.

When installing the subsequent rows, create a random appearance by using boards of different lengths to start each row (often the off-cut from the last board in the previous row is a suitable starter for the next). Make sure the minimum length of the starting boards in each row is 8" (300mm) and the end joints are staggered by minimum two board-widths.

EXPANSION SPACE

As a wood-based product, Evoke laminate flooring will expand and contract with changes in temperature. To allow for this, leave a 3/8" (10mm) expansion space around the entire perimeter of the floor between the flooring and the walls. Also leave expansion space where the flooring will meet any vertical obstacle, such as stairs, pipes, tiles, and cabinets etc. Pay particular attention that the proper expansion space is provided in and around doorways. Under-cutting the door jambs may be necessary to achieve the required spacing. Have a supply of 3/8" (10mm) spacers on hand during installation.

TRANSITIONS

T-mold transition strips are recommended at all doorway 32" wide or less into connected spaces. Failure to use the recommended transitions may result in flooring separations at or near doorways.

Evoke Laminate areas in excess of over 40' in any direction will require a T-mold transition strip to be incorporated into the floor.

Please note this laminate utilizes the 1 CLIC 2GO PURE drop-locking system. We recommend the use of a tap-block and a dead-blow hammer to avoid damage when engaging the end joints

Open 1 or 2 packages of flooring and inspect boards to ensure there are no manufacturing defects before proceeding with the installation. Continue to inspect as you go remember, boards that have been installed will be deemed to have been inspected and accepted by the customer.

1

Set the first board in place with the tongue facing the wall. Insert spacers.

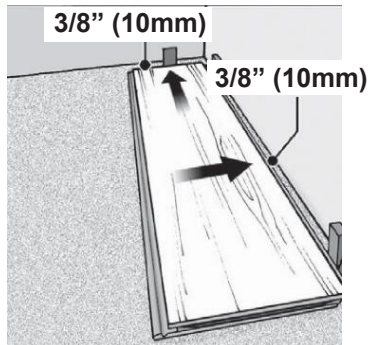

2

Install the second board by angling the end joint into the first board and lay the new board flat to engage the joint. Re-repeat for subsequent boards in the row. Use of a tap-block and deadbow may be required to seat the end-joint fully

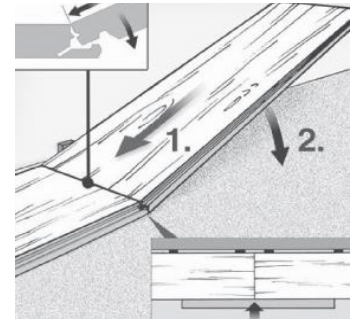

3

At the end of the row, cut a board to fit leaving expansion space. Use the off-cut to begin the next row.

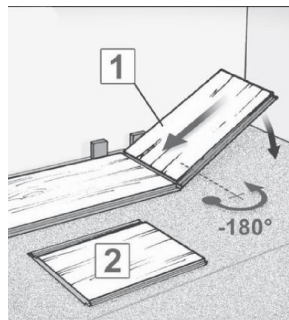

4

Begin the second row by angling the first board, insert the tongue into the groove of the first row and lay the board flat.

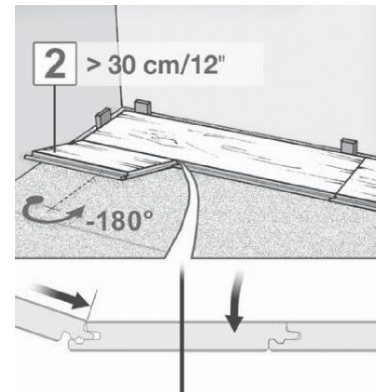

5

Hold the next board at a 20° angle to the previous row, align the end joint, and engage the long side joint. Lay the board down; it will not sit flat.

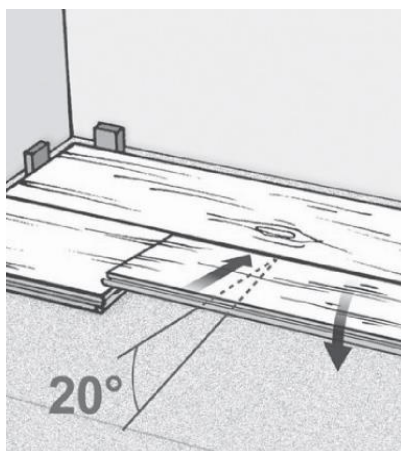

6

Recommend using a dead-blow hammer and tapping block to engage the end joint. Do not use a hammer or rubber mallet directly on the product as damage to the floor and the joint may result. Repeat for all subsequent rows.



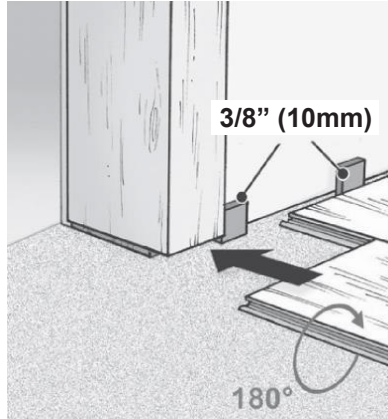
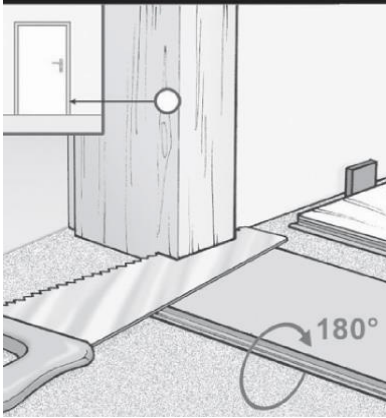

7

Undercut door jambs using a piece of flooring as a depth gauge so flooring can be installed under the mill work. Wherever the flooring meets a vertical obstruction (stairs, cabinetry) allow expansion space between the floor and the vertical surface.

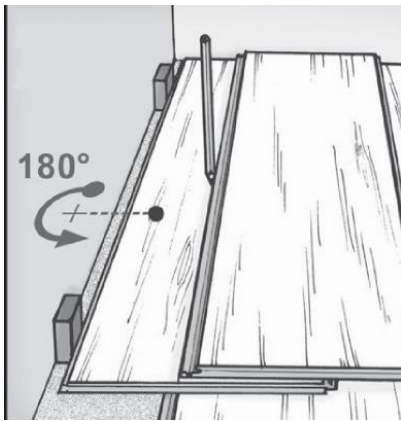

8

For the final row, rip a series of boards to the required width and install as illustrated. The use of T&G adhesive in these areas is recommended whenever boards are modified.

COMPLETING THE INSTALLATION

To complete the installation, install moldings, trim and transitions as needed. Remember, all moldings must be affixed either to the subfloor or to the wall – never to the flooring itself. After installing the moldings, apply a thin bead of 100% waterproof silicone caulking wherever the flooring surface meets a vertical fixture or object (eg. cabinets, moldings, baseboards etc.). This is only required in 'wet areas' where there is a high likelihood of routine spills, such as kitchens, baths, laundry rooms and so on. Likewise, where the flooring has been installed under a standing fixture like a toilet, pedestal sink or door frame, seal the base with a bead of silicone. This measure will help prevent any spilled liquid making its way to the underside of the laminate planks. If T-molds were installed to provide additional expansion points in the floor, these too must be sealed with a bead of silicone.

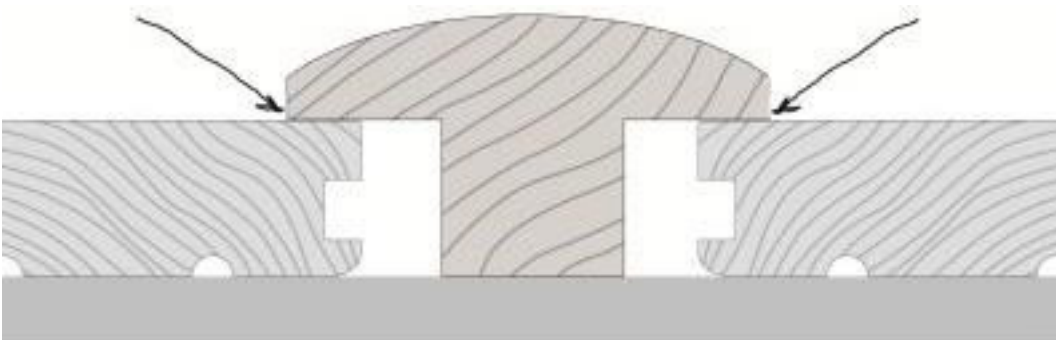

TO REMOVE EVOKE LAMINATE FLOORING

You will probably need one or two helpers, depending on how large the room is. First, remove all moldings and baseboards. Begin removing the floor at the last row that was installed. Using pry-bars and with helpers, lift the entire last row up by its outside edge to disengage the long side tongue and groove joint as shown in Step 1. Then angle the boards out at the ends as shown in Step 2.

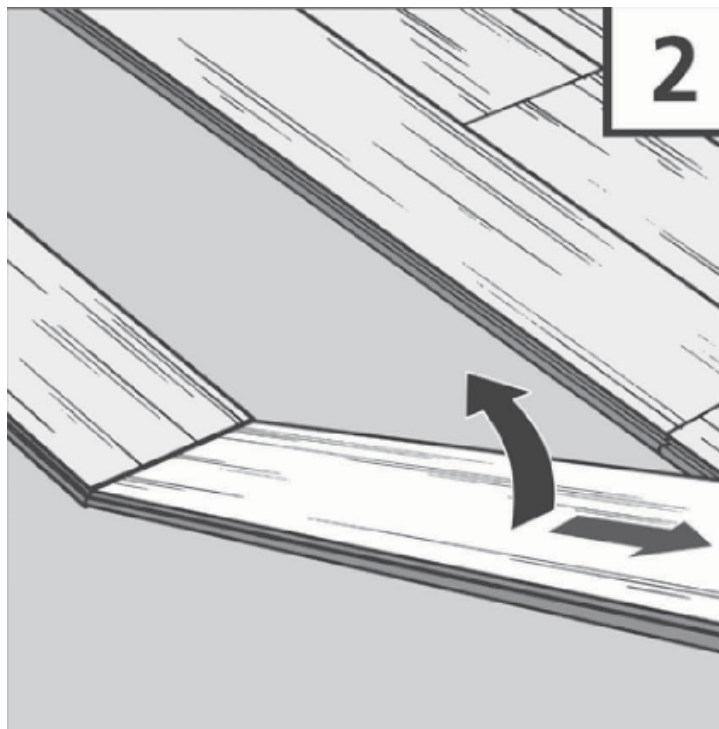
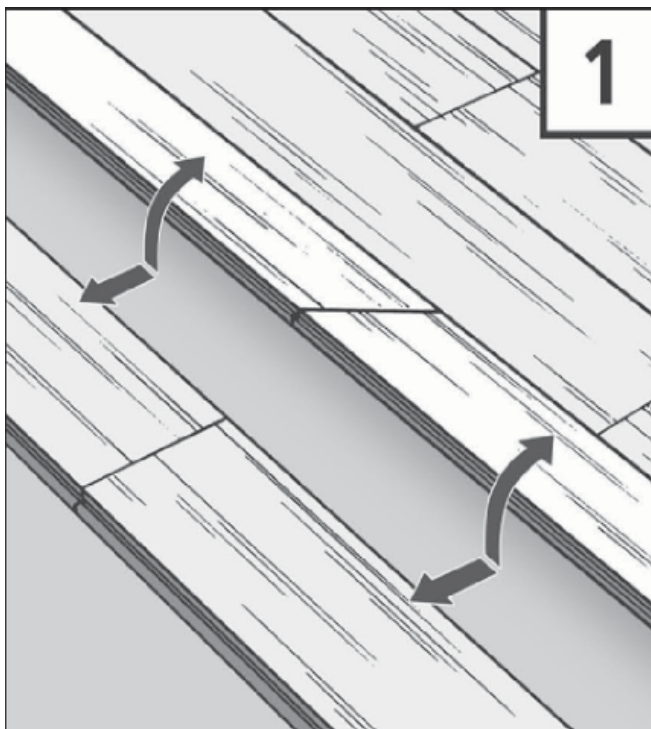

If the flooring was installed over a radiant heating system, when you turn the system back on bring the temperature of the system up gradually, in 5° increments. Never allow the surface temperature of the floor to exceed 82°F (28°C) and avoid dramatic temperature changes; always adjust the system gradually in 5° increments. It is recommended that a dedicated quick recovery thermostat be installed to allow the temperature of the radiant heating system to be accurately controlled. Before you move furniture onto the floor, take a moment to protect your new floor by putting felt pads on all furniture and accessories. To learn more about care and maintenance of your Evoke floor, please see the product warranty.

PRODUCT CARE & WARRANTY

PLEASE REFER TO THE EVOKE LAMINATE WARRANTY & MAINTENANCE DOCUMENT AVAILABLE ONLINE AT WWW.EVOKEFLOORING.COM FOR IMPORTANT INFORMATION ON HOW TO PROPERLY MAINTAIN YOUR FLOOR, AND THE APPROVED METHOD FOR CLEANING.

HERE ARE SOME BASIC CLEANING GUIDELINES:

- Sweep or vacuum the floor regularly to keep it clean and free of dust, sand and other abrasive materials.
- Place area rugs or doormats at entryways to help prevent sand, grit, oils, dirt and other abrasive materials from being tracked onto the floor surface from outdoors.
- Place protective mats at high-use work areas such as sinks, ranges, service counters and workstations.
- Protect the floor from exposure to excessive liquids, running water and other forms of excessive moisture. Blot up any spilled food, drink or other liquid promptly. Never wet mop the floor or use soap-based cleaners on the flooring. Use mats outside each entrance to prevent debris, oils, sand etc. from being tracked onto the floor. Place trays/ mats under potted plants and pet water dishes. Damage caused by flooding, broken pipes, wet mopping, steam cleaning or any other exposure to liquid or moisture that is not considered every day household spills is not covered under warranty.
- Ensure that environmental conditions are maintained with a temperature of 60-80°F (15-26°C) and humidity at 30-50% at all times. Because it is made from wood-based products, evo flooring reacts to changes in the environment. Problems resulting from exposure to improper environmental conditions are not covered by the product warranty.
- If the floor is installed over a radiant heating system, never allow the surface temperature of the floor to exceed 82°F (28°C). Avoid dramatic temperature changes; always adjust the system gradually in 5° increments. It is recommended that a dedicated quick recovery thermostat be installed to allow the temperature of the radiant heating system to be accurately controlled.
- Put felt protector pads on the feet of all furniture, display stands, file cabinets and other accessories that will be placed directly onto the floor surface. Inspect regularly for wear and replace as necessary.
- Avoid letting sharp or pointed objects come into contact with the floor surface.

For more info, visit: evokeflooring.com

